

APPROVED BUILDING COMPLETE PLAN OF
"VIJAY SINGH PATHIK COLLEGE"
AT- BANWARIPUR GAVADI MEENA (GAONRI)
NEAR BRIDGE SHRI MAHAVEER JI
TEH. HINDAUN CITY DISTT. KARALI (RAJ.)
PIN.322220 , KH. NO.- 28(¹¹⁴⁷/₂₈),29(¹¹⁴⁹/₂₉),30,31,38,39
TOTAL LAND AREA:- 12800 sq.mtr.

TOTAL BUILTUP AREA :- 55022.69 sq. ft.
5111.78 sq.mtr.
FOR B.A. , B.SC. ,MA , B.A.-B.ED /B.SC.-B.ED COURSE (ITEP)

KH.NO 29,30,38,39

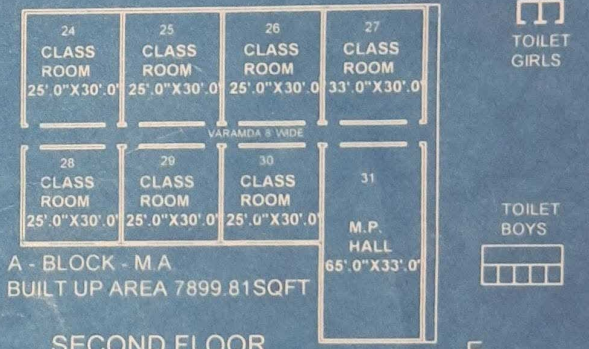
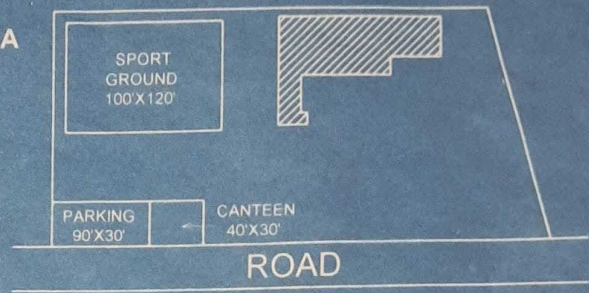

A - BLOCK - M A
BUILT UP AREA 7899.81SQFT



A - BLOCK
KH.NO.30,31
TOTAL BUILT UP AREA
12019.21 SQFT

GROUND FLOOR

B - BLOCK
BSC.BED.CLASS
KH.NO. 29,30
TOTAL BUILT UP AREA
8377.12 SQFT

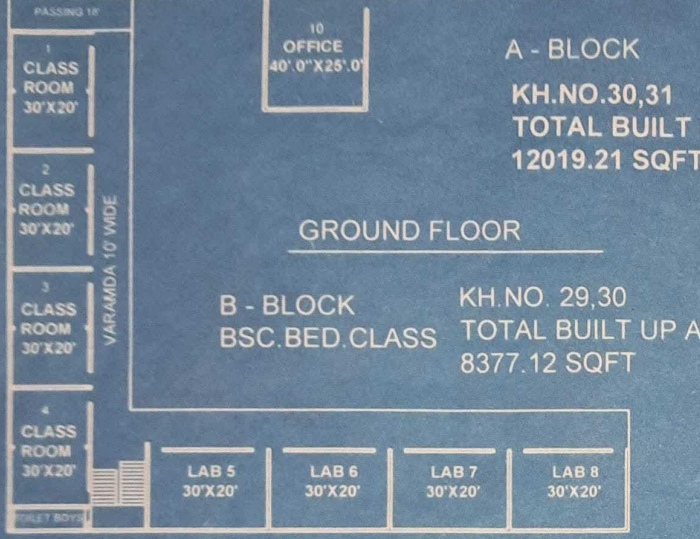

A - BLOCK
B.SC CLASS
KH.NO 30,31
BUILT UP AREA
11858.02SQFT

B - BLOCK
BA&BA.BED. KH.NO. 29,30
BUILT UPAREA 7579.78 SQFT

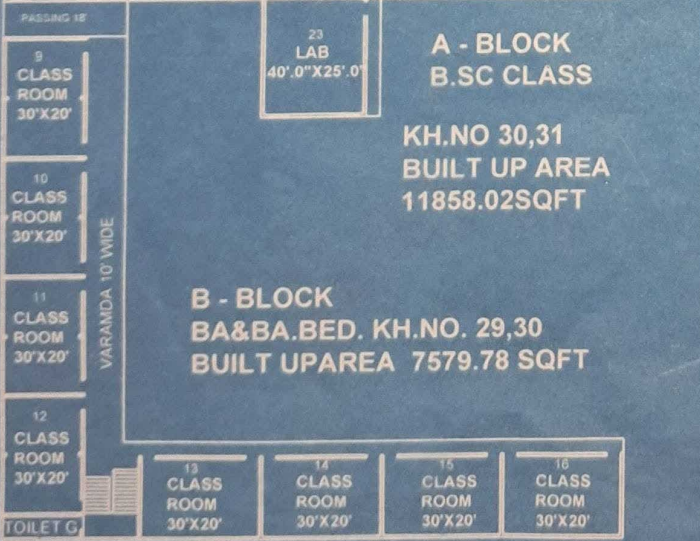

FIRST FLOOR

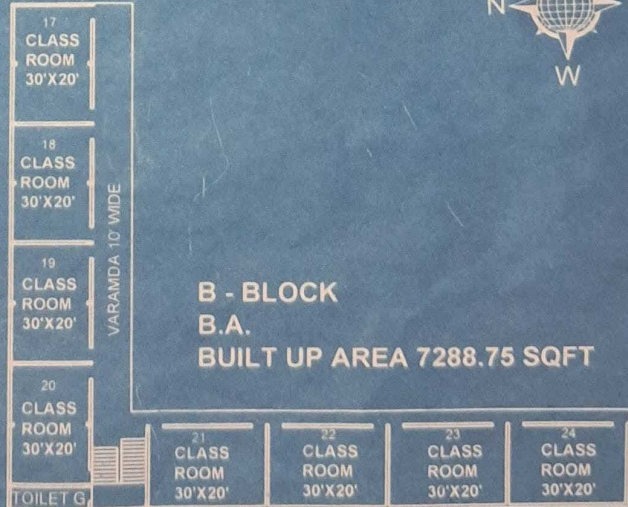

2nd. FLOOR

Signature
Bhomleram Associates
Reg. No.-SCA/2017/35/132705
Station Road, Hindaun City

Signature
सुनीता
सचिव 6/1/26
राष्ट्रीय आदर्श शिक्षा समिति
गुडाचन्दजी (गादौती)

Signature
प्राचार्य 6/1/26
विजयसिंह पथिक महाविद्यालय
श्रीमलमारी (करीली)

Signature
सहायक अभियन्ता
सां. निं. वि० हिण्डौन
करीली

PRODUCED BY AN AUTODESK STUDENT VERSION

PRODUCED BY AN AUTODESK STUDENT VERSION